

MIN. 7/16" OSB SHEATHING SEE RAFTER TABLE 3/8" X 4 1/2" LAG BOLTS @ 16" O.C.

APPROVED POST CAPS EA. POST

APPROVED RAFTER ANCHORS EA. RAFTER

SEE BEAM TABLE

REQUIRED WITH OPTION #1 ONLY
4X4 LATERAL BRACE
LAG BOLTED TO BEAM AND COLUMN

Any cold joint between footing and slab shall have a reinforced connection.

RAFTER SPAN		
Using DF#2, 30 psf-Ceiling Not Attached-IRC 2018-Table 802.4.1(B)		
SIZE	SPACING	MAXIMUM SPAN
2 x 4	12	9'-6"
	16	8'-3"
	24	6'-9"
2 x 6	12	14'-0"
	16	12'-1"
	24	9'-10"
2 x 8	12	17'-8"
	16	15'-4"
	24	12'-6"
2 x 10	12	21'-7"
	16	18'-9"
	24	15'-3"

BEAM SIZING		Roof Span							
Using DF#2		8'	9'	10'	11'	12'	13'	14'	15'
Post Spacing	8'	4x6	4x6	4x8	4x8	4x8	4x8	4x8	4x8
9'	4x8	4x8	4x8	4x8	4x8	4x8	4x8	4x8	4x8
10'	4x8	4x8	4x8	4x8	4x8	4x8	4x8	4x10	4x10
11'	4x10	4x10	4x10	4x10	4x10	4x10	4x10	4x10	4x10
12'	4x10	4x10	4x10	4x10	4x10	4x10	4x12	4x12	4x12
13'	4x12	4x12	4x12	4x12	4x12	4x12	4x12	4x12	4x12
14'	4x12	4x12	4x12	4x12	4x12	4x12	4x14	4x14	4x14
15'	4x14	4x14	4x14	4x14	4x14	4x14	4x14	4x14	4x16

When spans are close but slightly over, always round up to the next size.

APPROVED POST BASES
UNTREATED LUMBER A MIN. OF 1" ABOVE CONCRETE

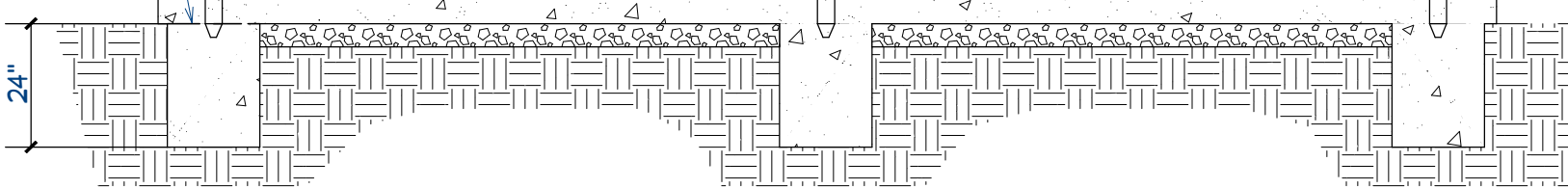

FOOTING SIZE		Roof Span				
Post Spacing	8'	10'	12'	14'	16'	
8'	12" dia. 8" thick	12" dia. 8" thick	12" dia. 8" thick	12" dia. 8" thick	13" dia. 8" thick	
10'	12" dia. 8" thick	12" dia. 8" thick	12" dia. 8" thick	13" dia. 8" thick	13" dia. 8" thick	
12'	12" dia. 8" thick	12" dia. 8" thick	13" dia. 8" thick	13" dia. 8" thick	14" dia. 8" thick	
14'	12" dia. 8" thick	13" dia. 8" thick	13" dia. 8" thick	14" dia. 8" thick	15" dia. 8" thick	

When spans are close but slightly over, always round up to the next size.

1. Porch shall not be attached to any manufactured home without an engineered design.
2. This handout is to be used as a guide only.
3. The term "approved" is a method or material approved by the Building Official.
4. The porch roof shall not attach to the house rafter tails/soffit/fascia.

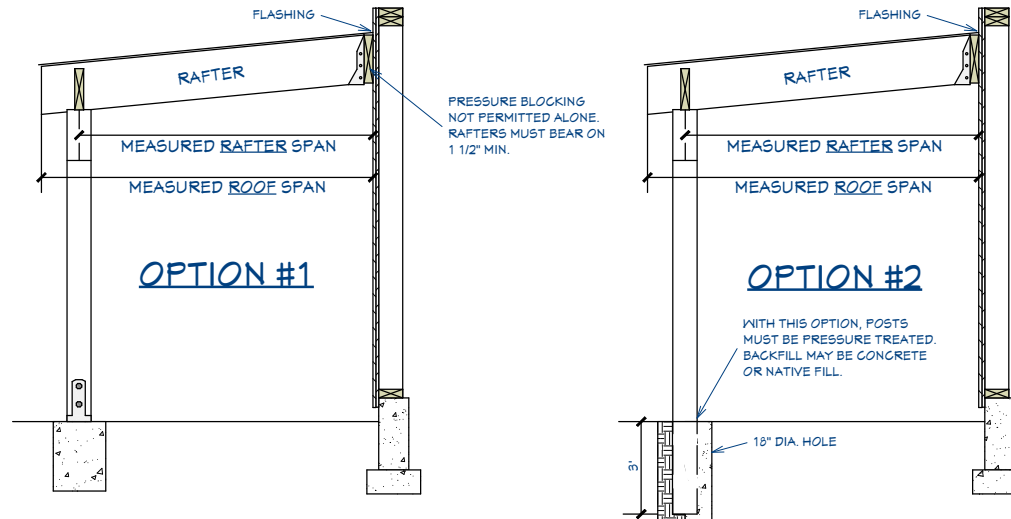

PROJECT DESCRIPTION:

PORCH EXAMPLE

CITY OF CALDWELL
Department of Building Safety
621 Cleveland Blvd
208-455-3024

DATE:

3-16-23

SCALE:

N.T.S.

SHEET:

A-1