

One of the following shall apply:

1. Continuously operated mechanical exhaust ventilation at a rate equal to 1 cfm for each 50 sq. ft. of crawlspace floor area, including an air pathway to the common area (such as a transfer grille).
2. Conditioned air supply sized to deliver at a rate equal to 1 cfm for each 50 sq. ft. of under floor area, including a return air pathway to the common area (such as a duct or transfer grille).
3. A plenum complying with section M1601.4, if under floor space is used as a plenum.

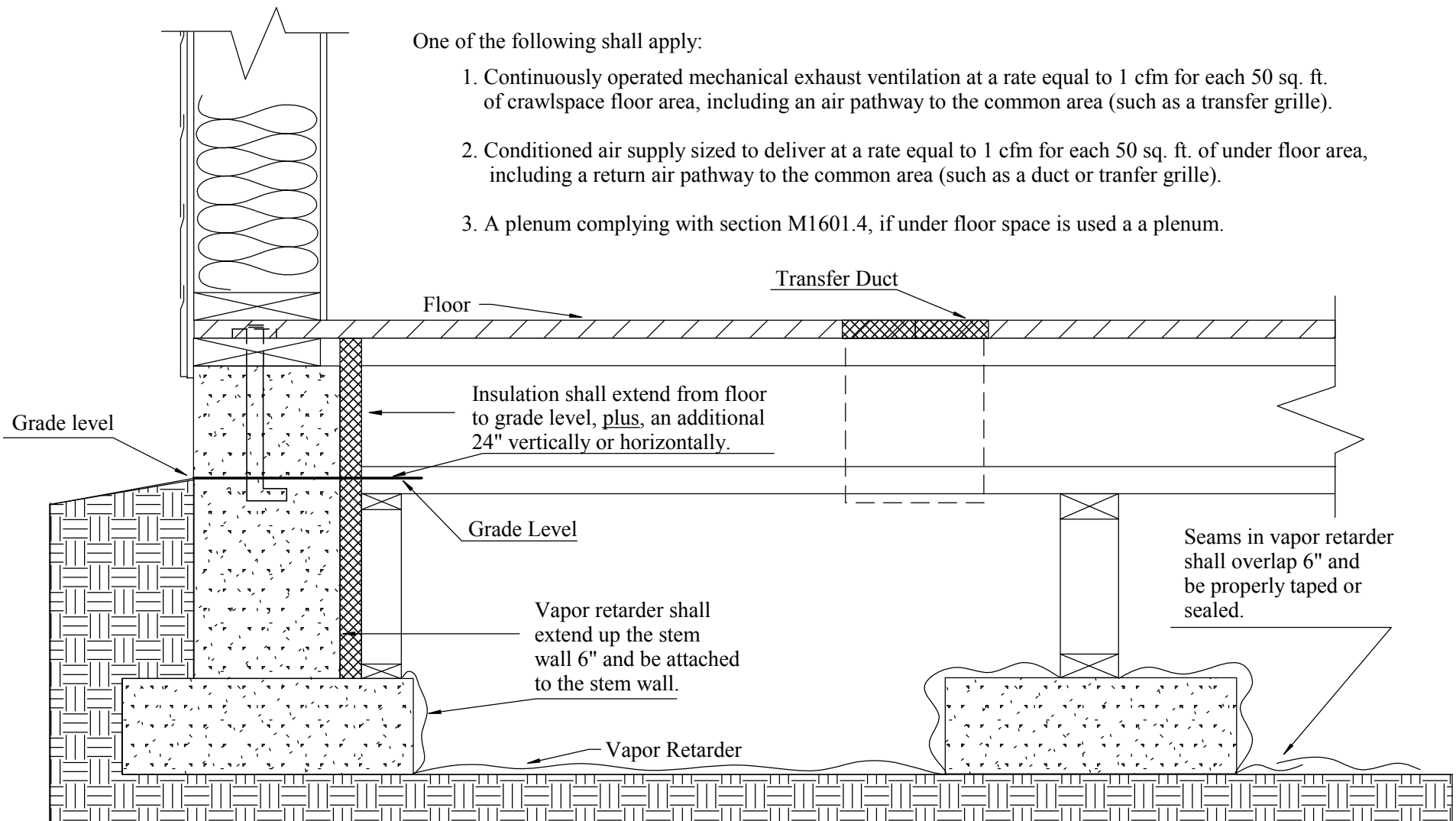

208-455-3024

Fax: 208-455-3050

*Department of
Building Safety*

TITLE

CONDITIONED CRAWLSPACE

SIZE	CAGE CODE	DWG NO	10-08	REV
SCALE	NTS	SHEET	1	